

St. Peters Place, Canterbury, CT1 2DB

£1,575 Per Month





## St. Peters Place

Canterbury CT1 2DB

STUDENT ACCOMMODATION 2026-27 (Available from August 2026)

This 3 bedroom student house is located within the city walls and bills listed below are included. Entrance into hallway with ground floor bedroom to front, sitting room leading to kitchen and downstairs shower room. Rear enclosed garden with side access. Upstairs has 2 double bedrooms.

Available 1st August 2026

12 month Tenancy

Rent - £1575 (£525 per person x3)

Deposit - £1817

This can be paid any time until your tenancy begins (EXCLUDING Holding Deposit)

Students/sharers only

Furnished

Individual locks on bedrooms: Yes

All double beds: Yes

Council tax band: B

Each applicant will require a Guarantor who lives in England, Scotland, Wales or Northern Ireland. If you are not able to provide a guarantor that meets these requirements you should be able to use a Guarantor service such as Housing Hand or Your Guarantor (If registered to UKC)

Please refer to the fee's tab on our website ([www.sallyhatcher.co.uk](http://www.sallyhatcher.co.uk)) for all information on fee's and deposit options







Floor Plan

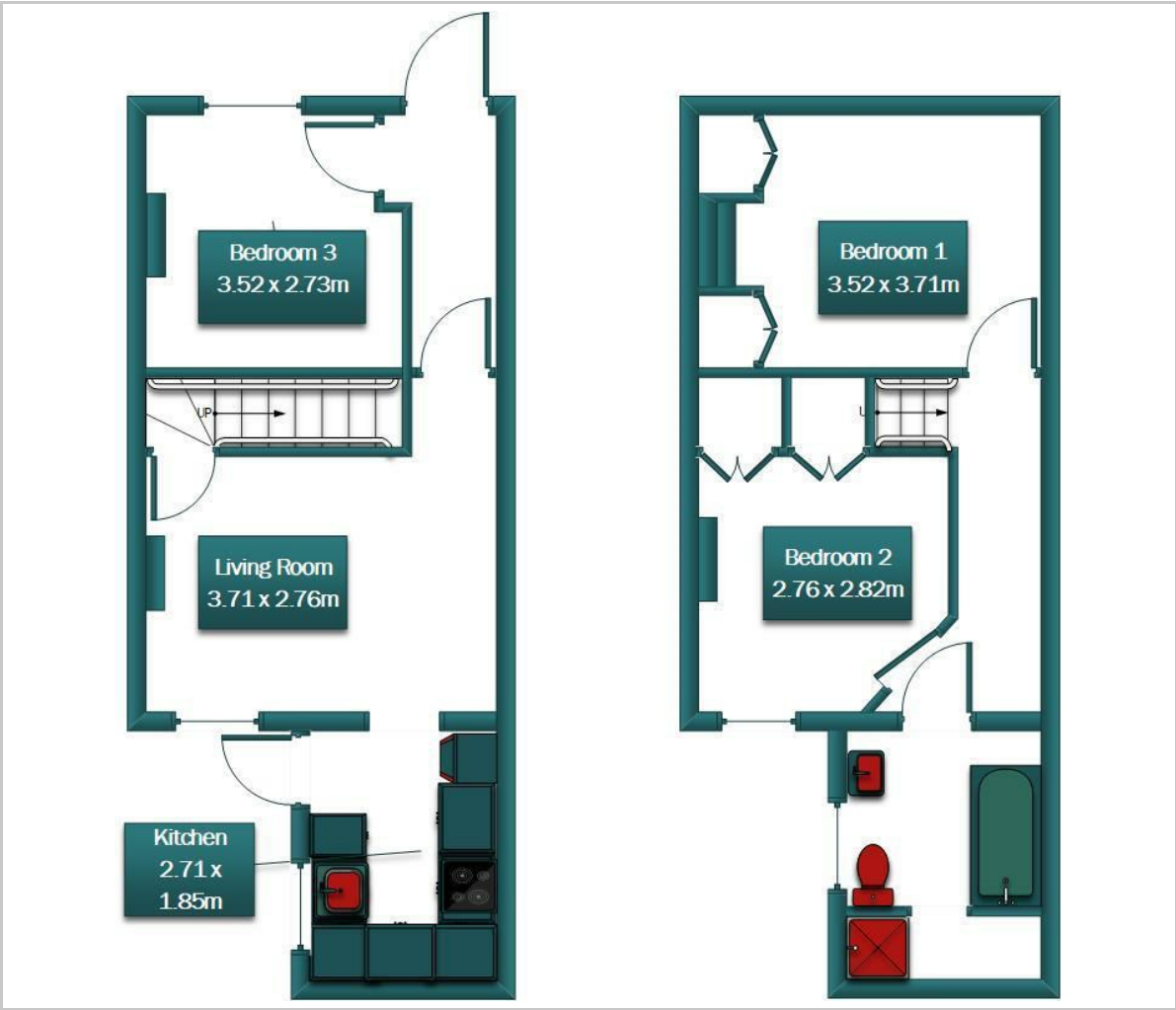

Viewing

Please contact us on 01227 733888 if you wish to arrange a viewing appointment for this property or require further information.

These particulars, whilst believed to be accurate are set out as a general outline only for guidance and do not constitute any part of an offer or contract. Intending purchasers should not rely on them as statements of representation of fact, but must satisfy themselves by inspection or otherwise as to their accuracy. No person in this firms employment has the authority to make or give any representation or warranty in respect of the property.

Area Map



Energy Efficiency Graph

